

# PremiLine

*Magnificent views*



334 PR 0980\_0214\_KE

**PremiLine** sliding window/door system



profine GmbH  
KBE Fenstersysteme  
Motzener Str. 31-33  
12277 Berlin  
Phone: +49 (0)30 86873-0  
Fax: +49 (0)30 86873-386  
Email: [kbe@profine-group.com](mailto:kbe@profine-group.com)  
[www.kbe-online.de](http://www.kbe-online.de)



# Your comfortable *sliding system*

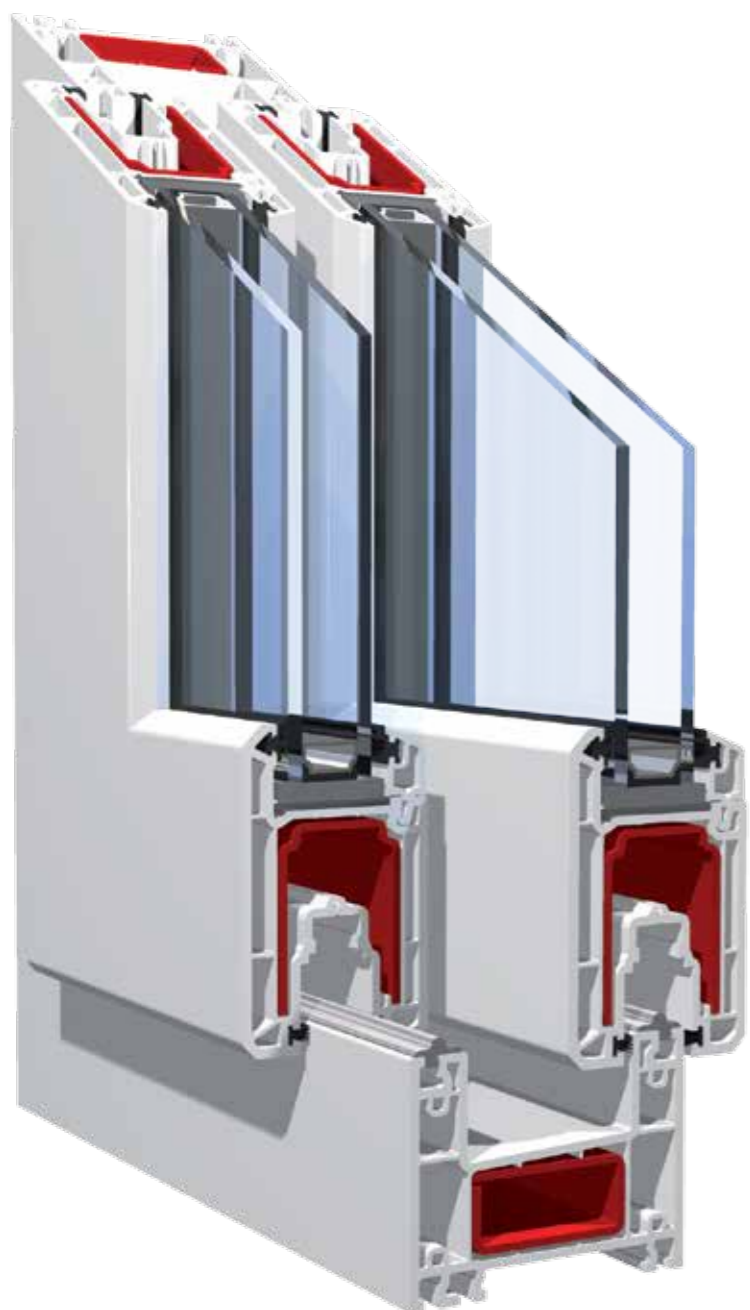

Quiet. Long lived. Safe.

There are many kinds of comfort. With PremiLine, the exceptionally quiet sliding system, you'll learn a few more.

## Comfort has many faces

For instance, when a PremiLine sliding system is opened and closed. Its precision fits make it extremely quiet and easy to use. Even with large glazed areas, the PremiLine profiles ensure that the sliding elements move in near perfect silence, a result of the window and door sashes' high stability.

## Safety

Thanks to the excellent static properties of the underlying design, PremiLine sliding elements also provide a high level of security. And because PremiLine sliding elements also exhibit particularly long service lives, you can safely lean back and now enjoy more comfort when your PremiLine sliding elements run on high quality stainless steel tracks – Quiet. Long lived. Safe.



# Magnificent views



Whether wide or high – thanks to PremiLine profiles, also generous dimensions are now possible on sliding doors: the optimal frame for a magnificent view.

A sliding door is an important and style shaping element for your house and home. PremiLine profiles give sliding elements an appealing, distinctive look – thanks to the double chamfered sash profiles. The steel reinforcement and the aluminium reinforced centre section provide convincing static properties, also for the generous dimensioning of the sliding elements. A range of frame casements are available for the various installation conditions.

So you you can enjoy the maximum freedom when dimensioning the height and width of your door. Comfort to measure.

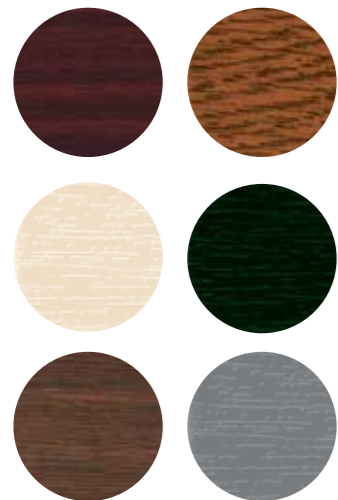

Excerpt from the laminate colour range



A practical addition: the integrated letterbox

- » Distinctive, double chamfered sash profiles with gaskets in black or light grey
- » There are many possible glazing types to choose from. And of course, divided sliding elements can also be fitted with Georgian bars. Special functional glazing is possible with panes up to 28 mm thick.
- » On request a letterbox can be integrated in your PremiLine sliding door.
- » Besides white, PremiLine is also available in laminated designs. You can choose either wood grain or plain colour for the outside – with neutral white on the inside – or wood grain for inside and outside.

**greenline**

*Our greenline principle:  
Energy efficient window systems,  
lead free stabilisers in virgin  
material, and intelligent regrind  
concepts provide for that extra  
sustainability.*

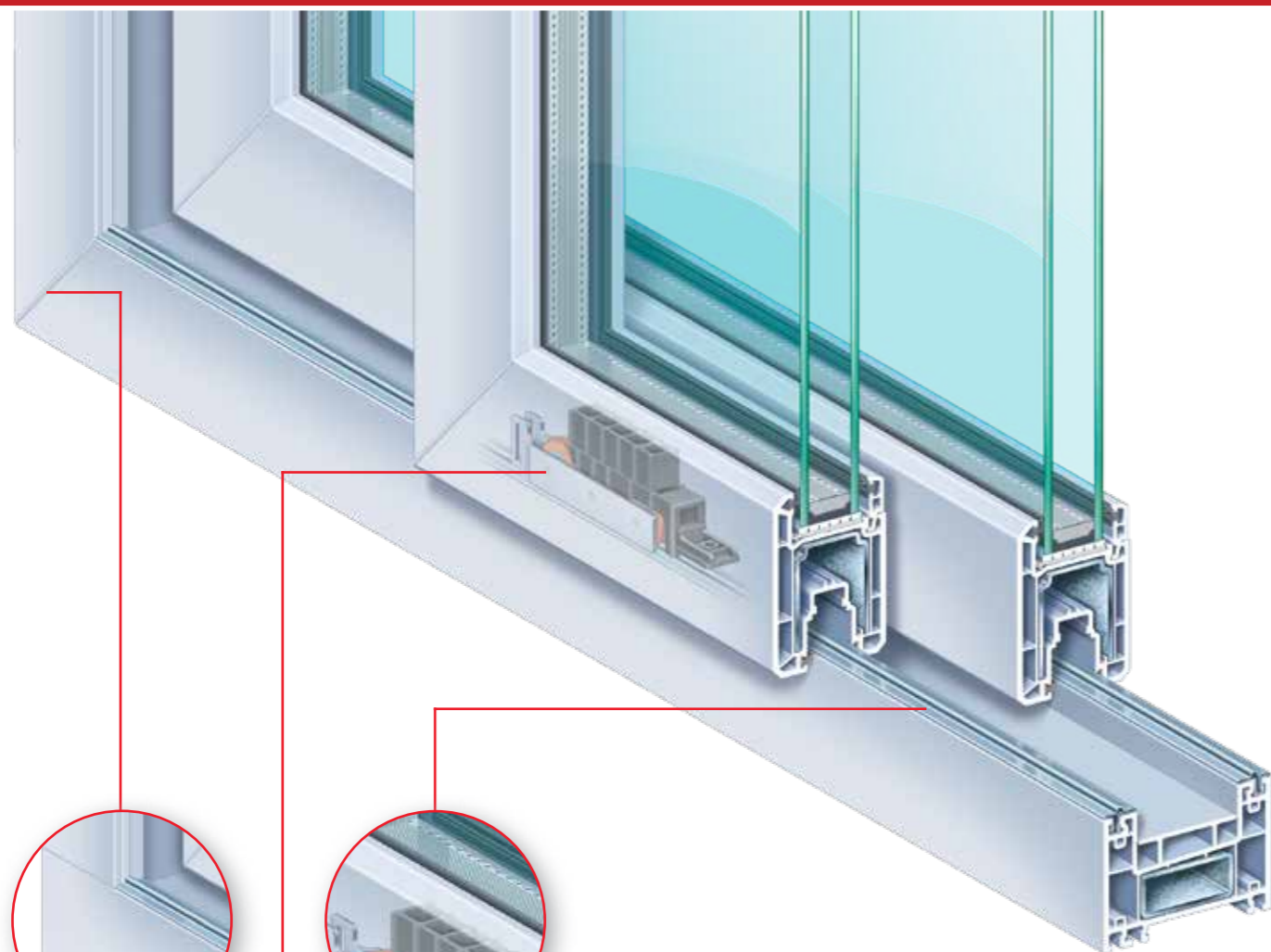

Profile corners also with straight connections



Tracks of high quality stainless steel for maximum service life

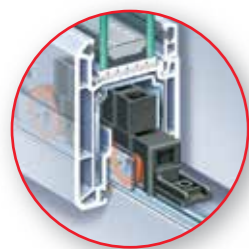

Thanks to rollers of special rigid PVC, the system promises exceptional quiet running and ease of operation.

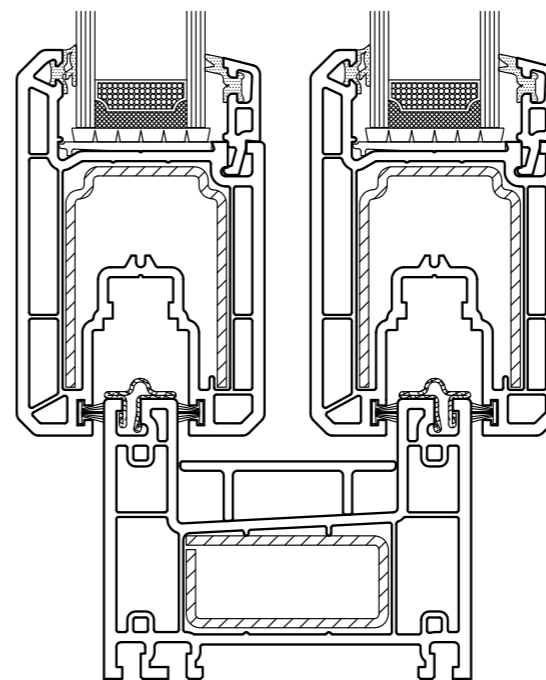

The PremiLine profile is a three chamber design with an installation depth of 80 mm in the frame and 54 mm in the sash.

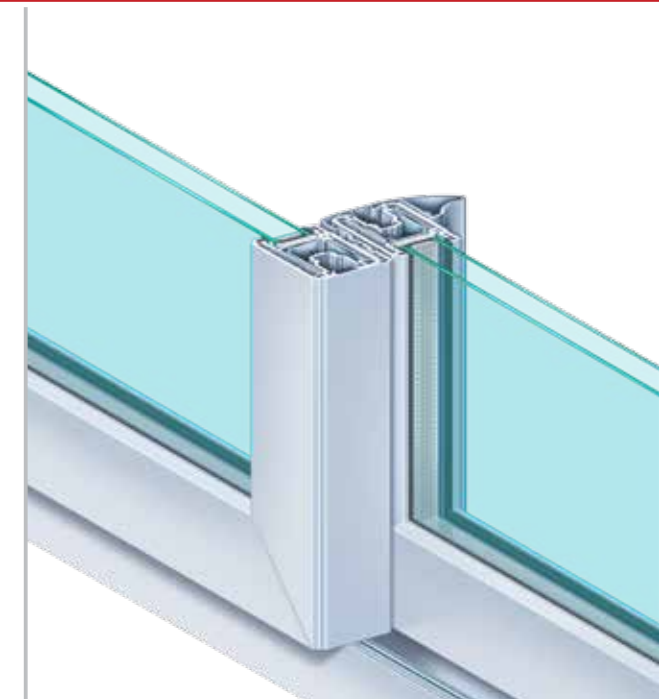

### A flexible system

PremiLine elements also exhibit convincing versatility. This flexible system allows the most diverse opening modes.



Sliding window with two sliding sashes

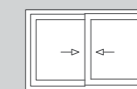

Sliding window with two sliding sashes and fixed glazing unit



Two-part element with two sliding sashes



Two-part element with sliding door and fixed glazing unit

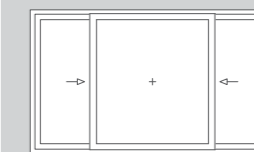

Three-part element with two sliding sashes and central fixed glazing unit

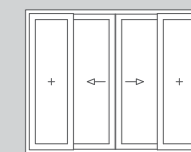

Four-part element with two sliding sashes and two fixed glazing units

Many of the advantages presented by PremiLine elements are clear to see. Many, on the other hand, are in the detail.

The double chamfered sash profiles are responsible for the distinctive design. In addition, the profiles are compatible with all 70 mm standard window systems. A further advantage lies in the profile's structure: the outer frame can be either welded or secured mechanically on site. When particularly large sliding door systems are to be installed, the elements can then be transported easily through confined stairwells.

The highest quality and the perfect interaction of all components are the most important conditions for the optimal overall design. These are good reasons in favour of the technical details presented by the PremiLine elements.

### This structure and the good static properties present many advantages:

- » Sliding windows and sliding doors can be offered in two, three, or four part designs
- » Minimum wearing for ease of operation, quiet running, and long service life
- » Large glazed areas possible with aluminium reinforced centre section with full-length handle
- » A range of frame casements for various installation conditions
- » Outer frames can be welded or connected mechanically